

SMART BOAT OWNER

La soluzione più
attuale e easy
per vivere la tua
barca da sogno

SPECIFICATIONS

LENGTH	11,42 mt
BEAM	6,59 mt
DRAFT	1,15 mt
CABINS	3
TOILETTES	2
ENGINES	Yanmar 2x29 hp
SAIL AREA	77 mq
WATER CAPACITY	2x300 lt
FUEL CAPACITY	2x200 lt



+39 0566 866094



sales@parallelo43.it



www.parallelo43.it



EXCESS 11

Cost per share 1/6 - € 102.400

43° Parallelo offer:

€96.000

+ maintenance and managing annual costs

* VAT included

Base: Marina di Scarlino

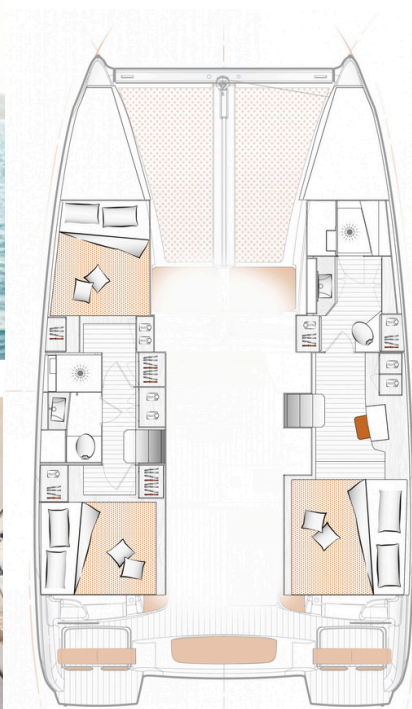

SMART BOAT OWNER

EXCESS 11

VERSION

3 cabins and 2 toilettes - Woods:
Cedar + berth in port bow
compartment

DELIVERY

- Transport
- Launching, rigging, antifouling

PACK SAIL AWAY

- Electric Pack (AC electric circuit: 32A Shore Power, USB and 220V outlets, 40A charger, additional 2x 140A AGM batteries with controller)
- "Garmin" Electronics (Starboard helm station: 12" GPSMAP display, Worldwide cartography) - (Portside: Tablet support) - (Chart table: 315 VHF single handset, portative compass) - (Speed-Depth-Temp transducer, Wind transducer, Autopilot)
- Starboard double helm seat
- Deck searchlight
- Opening hatches x2 in forward roof windows
- Cockpit led lights

PACK PULSE LINE

- Pulse Line Rigging & Sail Plan
- Square top mainsail and self-tacking jib in grey Pro-Radial
- Code 0 rig and pole & furler (Manual winch on port)
- Barber hauler
- Textile lifelines (Instead of standard)
- Pulse Line steering wheels x2 - Color: orange
- Pulse Line hull decoration
- Orange textile interior handles

ELECTRONIC

- AIS 800 Garmin Transceiver
- Fusion Sound pack in saloon and cockpit
- Inverter 12/230V 2000VA

HYDRAULIC CIRCUIT

- Additional fresh water tank 300 lt
- Electric sea water pump with dedicated tap
- Water maker 12V; 50 lt
- Sea water electric toilets

EXTERNAL EQUIPMENT

- Starboard 40.2 electric winch
- Lazy bag - color "Charcoal Grey"
- Composite cockpit table extension
- Stainless-steel davits
- Led cockpit lighting
- Portside additional double helm seat
- Cockpit closure
- Front sun shade
- Forward cockpit cushions
- Aft-cockpit cushions
- Roof ladders
- Anchor set-up (20 kg Delta anchor, 75 mt chain 10 mm, 20 mt rope 18mm)
- Polyform F4 fenders with covers (8)
- Polyform A3 stern fenders with covers (2)
- External upholstery colour: orange
- Dinghy with aluminium keel with outboard engine 6 HP
- Outboard engine brackets
- Security equipment 8 people within 50 miles
- 2 gas bottles
- Shorepower cable 12 mt with 16/32 AH adapter
- Boat's name and plates
- Solar panels
- Gangway with cover
- Pair of 3-blades folding propellers

INTERNAL EQUIPMENT

- Internal upholstery colour: PVC Chalk
- Lockers in saloon and galley
- Additional berth in saloon
- Sun shades in dinette - color: mist
- Kerrock countertop in galley
- Diesel forced air heating
- Freezer 55 lt
- Galley equipment
- Saloon cushions covers
- Cabin mattress covers
- Nespresso coffee machine

